

Generic Form 15—Compliance Certificate for building Design or Specification

NOTE	<p>This is to be used for the purposes of section 10 of the <i>Building Act 1975</i> and/or section 46 of the <i>Building Regulation 2006</i>.</p> <p>RESTRICTION: A building certifier (class B) can only give a compliance certificate about whether building work complies with the BCA or a provision of the QDC. A building certifier (Class B) can not give a certificate regarding QDC boundary clearance and site cover provisions.</p>	
1. Property description This section need only be completed if details of street address and property description are applicable. EG. In the case of (standard/generic) pool design/shell manufacture and/or patio and carport systems this section may not be applicable.	Street address <i>(include no., street, suburb / locality & postcode)</i> XX Lot & plan details <i>(attach list if necessary)</i> XX In which local government area is the land situated? XX	
2. Description of component/s certified	Summermore Pty Ltd confirm that we have designed the 100 x 65, 150 x 65 and the 200 x 65 Shurelock Beam Splices at Supports with Tie Downs as shown on the attached drawing 13-6170-S01.	
3. Basis of certification	AS1170.0, AS1170.1, AS1170.2, AS4100, AS3566.	
4. Reference documentation	13-6170-S01.	
5. Building certifier reference number	Building certifier reference number _____	
6. Competent person details	Name <i>(in full)</i> Ronald Albert BELL Company name <i>(if applicable)</i> Summermore Pty Ltd Contact person Ronald Bell Phone no. <i>business hours</i> 07 38000973 Mobile no. 0438288116 Fax no. 07 38001860 Email address ron@summermore.com.au Postal address PO Box 1671, Browns Plains BC, Queensland, 4118 Licence or registration number <i>(if applicable)</i> RPEQ 6715	
7. Signature of competent person This certificate must be signed by the individual assessed by the building certifier as competent.	Signature 	Date Tuesday, May 14, 2013

LOCAL GOVERNMENT USE ONLY

Date received	Reference Number/s	
---------------	--------------------	--

The *Building Act 1975* is administered by the
Department of Housing and Public Works



**Queensland
Government**

GENERAL

1. THESE DRAWINGS SHALL BE READ IN CONJUNCTION WITH ALL ARCHITECTURAL AND OTHER CONSULTANTS DRAWINGS, SPECIFICATIONS AND WITH SUCH OTHER WRITTEN INSTRUCTIONS AS MAY BE ISSUED DURING THE COURSE OF THE CONTRACT. ALL DISCREPANCIES SHALL BE REFERRED TO THE SUPERVISING OFFICER FOR DECISION BEFORE PROCEEDING WITH THE WORK.
2. NO RESPONSIBILITY WILL BE TAKEN BY THE CONSULTING ENGINEER FOR DIMENSIONS OBTAINED BY SCALING THE STRUCTURAL DRAWINGS.
3. ALL DIMENSIONS SHALL BE VERIFIED ON SITE BY THE CONTRACTOR WHO SHALL BE RESPONSIBLE FOR THEIR CORRECTNESS. ALL DIMENSIONS IN THESE DRAWINGS ARE APPROXIMATE AND ARE FOR THE SOLE PURPOSE OF ASSISTING THE STRUCTURAL DOCUMENTATION.
4. THE CONTRACTOR SHALL BE RESPONSIBLE FOR MAINTAINING THE STRUCTURE AND NEIGHBOURING STRUCTURES IN A SAFE AND STABLE CONDITION DURING CONSTRUCTION. NO PART SHALL BE OVERSTRESSED.
5. ALL MATERIALS AND WORKMANSHIP SHALL BE IN ACCORDANCE WITH THE REQUIREMENTS OF THE CURRENT S.A.A. CODES AND THE BY-LAWS AND ORDINANCES OF THE RELEVANT GOVERNMENT AUTHORITY.
6. THE STRUCTURAL WORK SHOWN IN THESE DRAWINGS HAS BEEN DESIGNED FOR THE FOLLOWING LOADS:
ROOF LIVE LOAD - 0.25 kPa
7. PROPRIETARY ITEMS SHALL BE INSTALLED IN STRICT ACCORDANCE WITH THE MANUFACTURER'S SPECIFICATION.
8. "SUPERVISING OFFICER" WHERE READ IN THE DRAWING NOTES MAY BE SUBSTITUTED BY THE "SUPERVISING ENGINEER", THE "INSPECTING ENGINEER", THE "SITE SUPERINTENDENT" OR OTHER, AS DETAILED IN THE TECHNICAL SPECIFICATION (IF REQUIRED).
9. IF THERE IS A DISCREPANCY IN THE MEMBER SIZES FOR ANY COMPONENT, ASSUME FOR PRICING PURPOSES ONLY THAT THE LARGER OR MORE EXPENSIVE SIZE IS CORRECT. REFER TO STRUCTURAL ENGINEER FOR DECISION BEFORE DETAILING OR CONSTRUCTION.

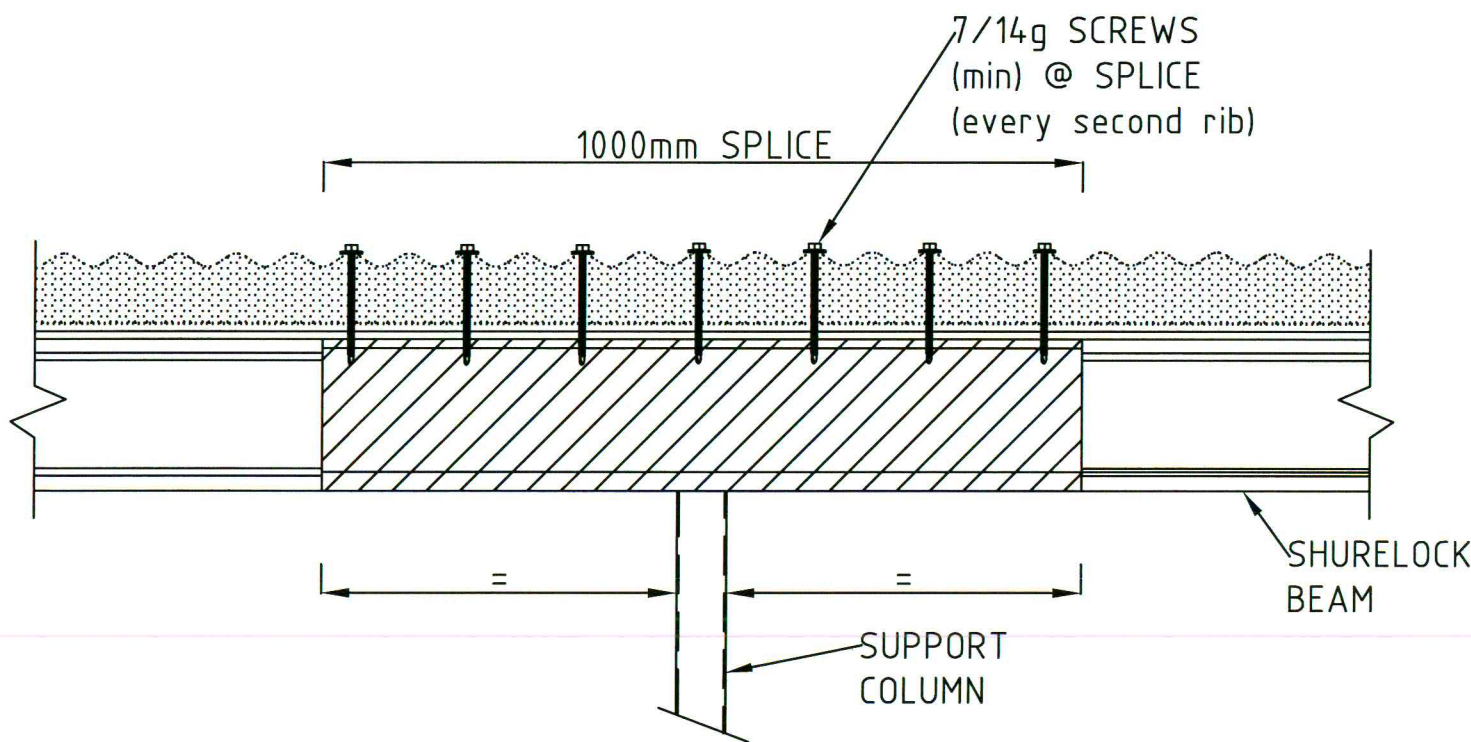
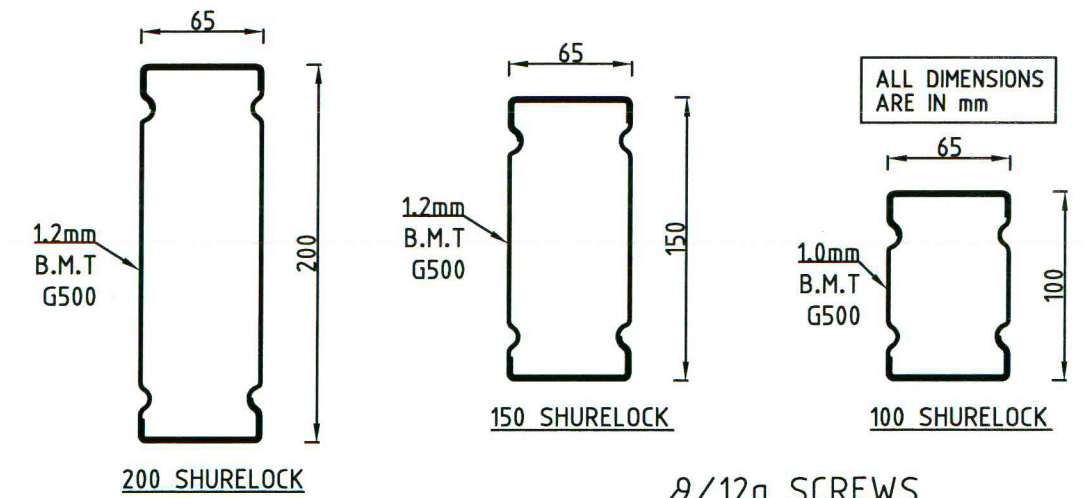
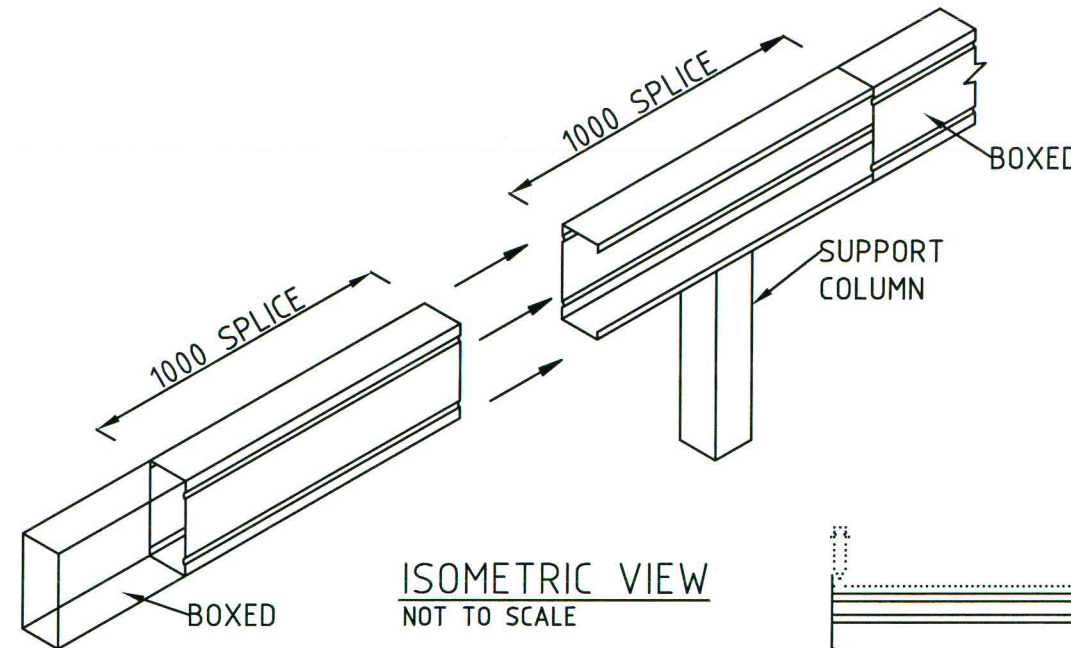

CORRUGATED INSULATED PANEL
ELEVATION VIEW
SCALE 1:10

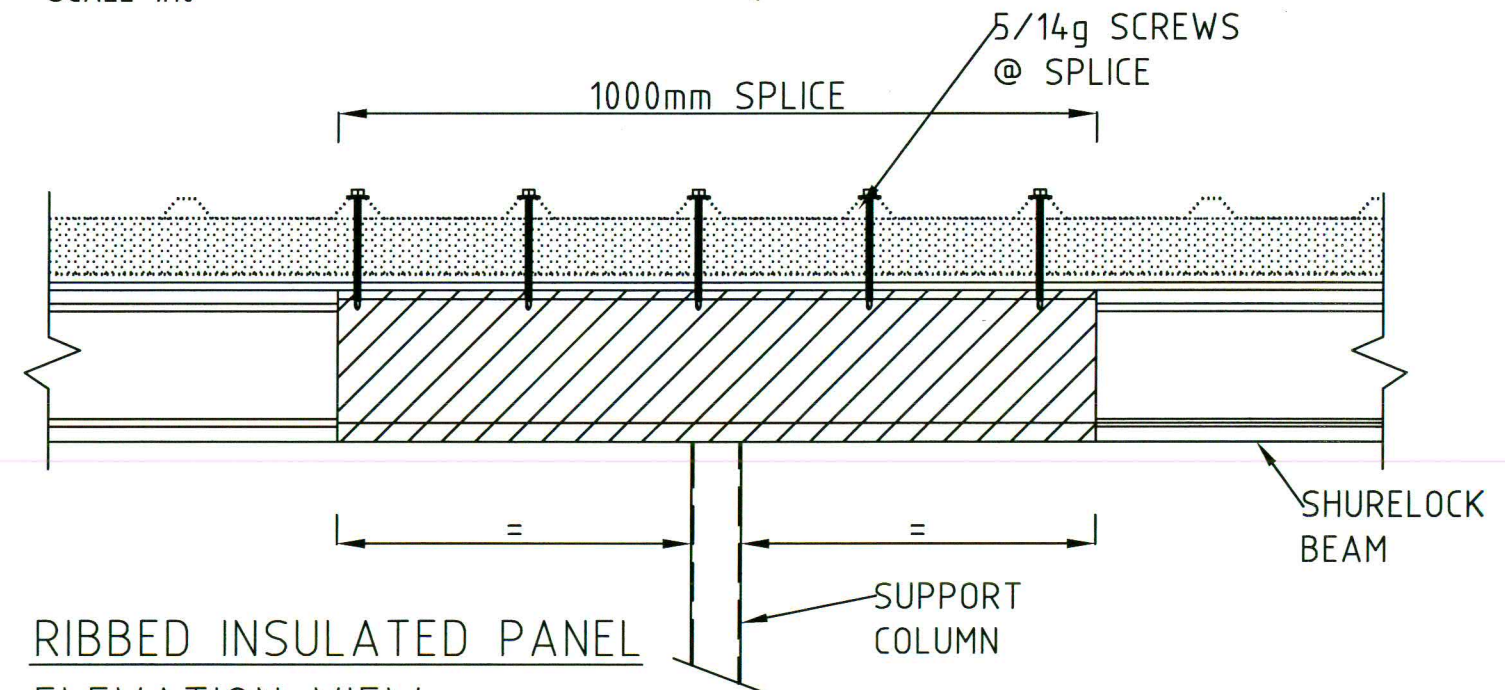
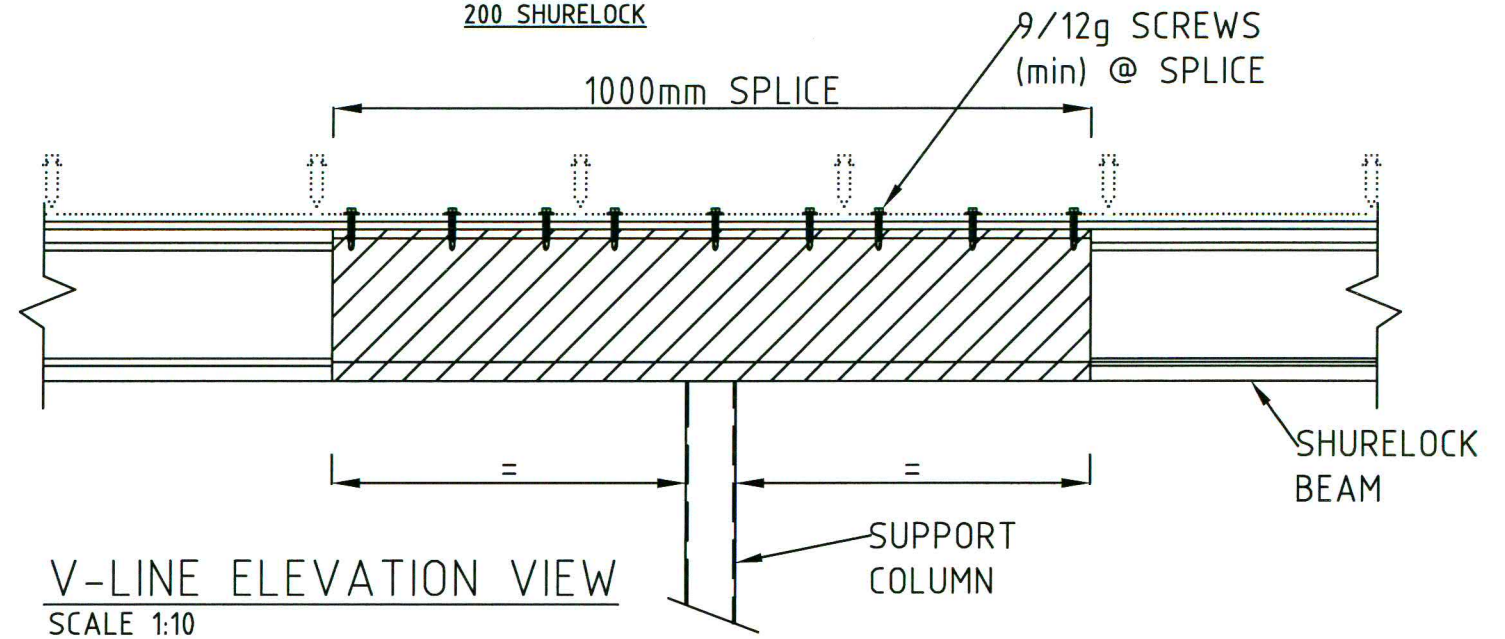

RIBBED INSULATED PANEL
ELEVATION VIEW
SCALE 1:10

DRAWING REVISIONS				REFERENCE DRAWINGS				COPYRIGHT THESE DESIGNS, PLANS AND INFORMATION ARE COPYRIGHT AND ARE NOT TO BE USED OR REPRODUCED WHOLLY OR IN PART OR TO BE USED ON ANY PROJECT WITHOUT THE WRITTEN PERMISSION OF SUMMERMORE PTY LTD				SIGNED APPROVAL				CLIENT				PROJECT																																																																																																																																																																																																																																																																																																																																																																																																																																																																																																																																																																																																																																																																																																																																																																																																																																																																																																																																																																																																																																																																																																																																																																																																																																																																																																																																																																																																																																														
																																																																																																																																																																																																																																																																																																																																																																																																																																																																																																																																																																																																																																																																																																																																																																																																																																																																																																																																																																																																																																																																																																																																																																																																																																																																																																																																																																																																																																																																		</